

## Setup

### 1 Description of XaviXPORT.

#### Package contents of XaviXPORT

XaviXPORT (1)	A/V Cable (1)	Power Adaptor (1)	User's Guide (1)
Quick Set-up Guide (1)	Registration Card (1)	Serial No. Label (4)	

#### Front view

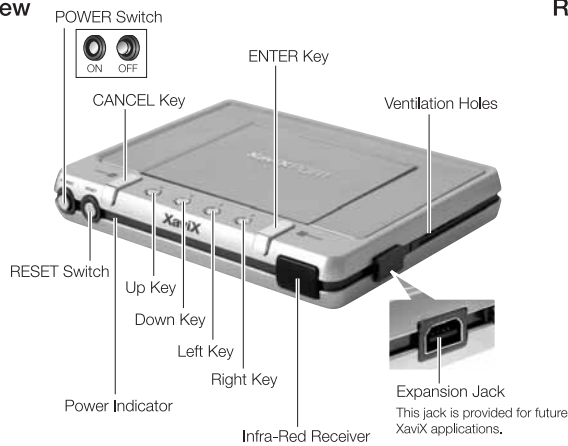

#### Rear view

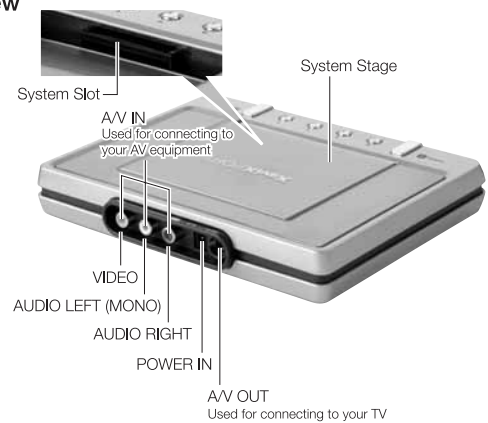

### 2 Setup XaviXPORT.

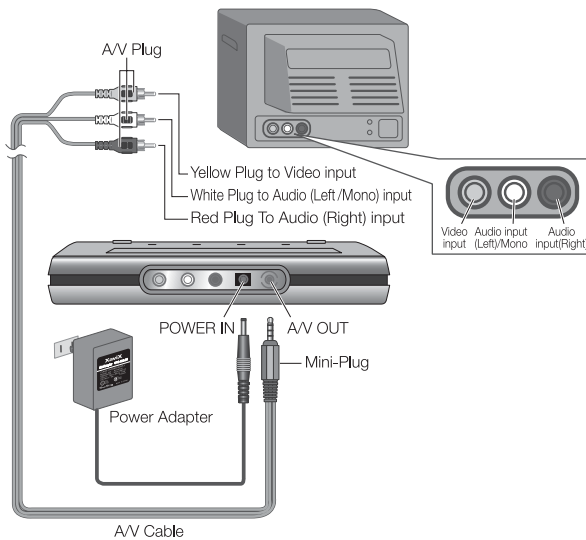

Please be sure that the A/V mini-plug is firmly inserted into the back of the XaviXPORT.

Where you place the XaviXPORT depends upon the system title. Read and follow the instructions in the User's Guide of each system title to determine the best position to place the XaviXPORT.

### 3 Insert System Cartridge.

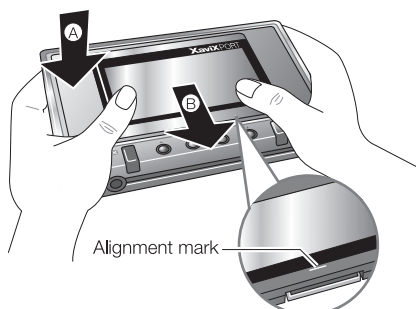

INSERT the cartridge into the PORT and slide the cartridge towards the front of the PORT. Press the PORT power switch and check to be sure the green power light is on.



Make sure that your XaviXPORT is turned off before you insert the system cartridge to the PORT.