

# Quick Setup Guide

## Setup

### 1 Description of J-MAT.

#### Package contents of J-MAT

System Cartridge (1)	J-MAT (1)	Hand Weights (2)	User's Guide (1)
Quick Set-up Guide (1)	Registration Card (1)	Serial No. Label (4)	

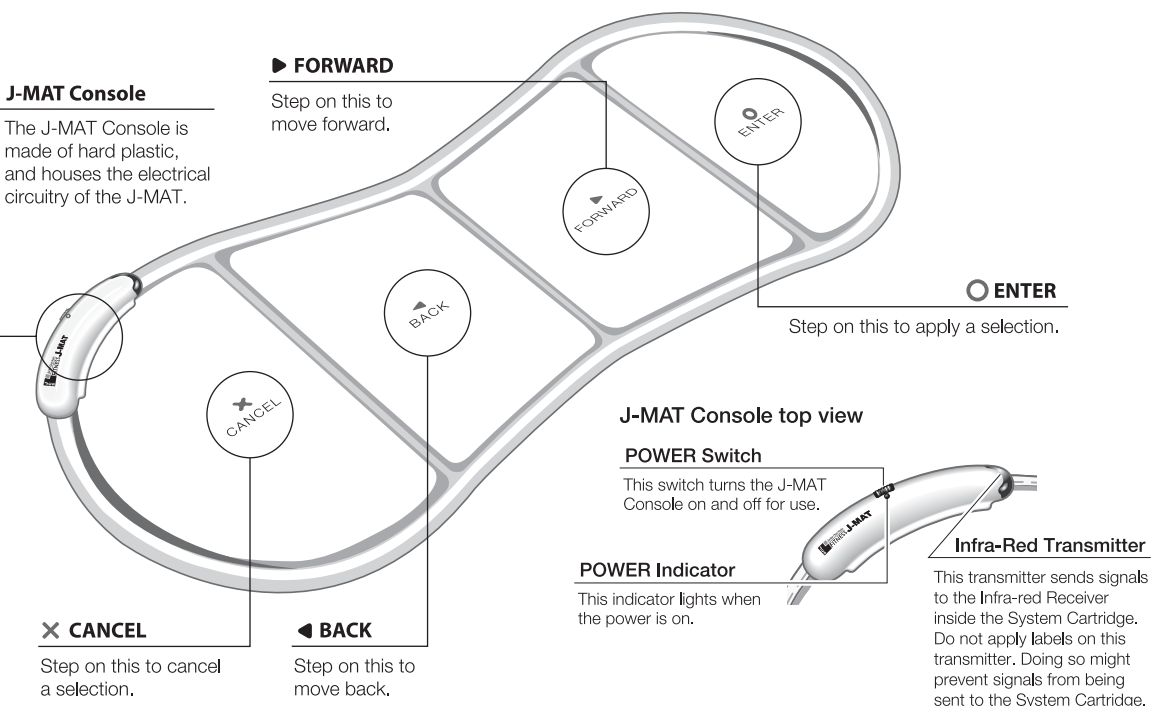

### 2 Setup XaviXPORT.

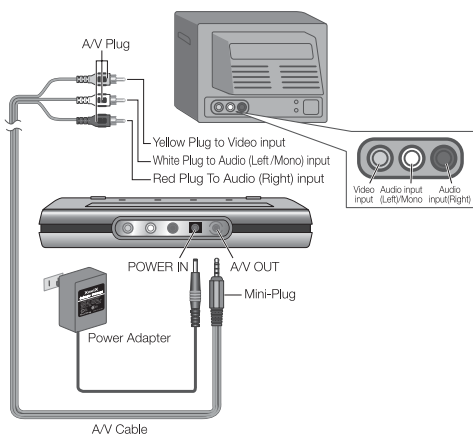

Please be sure that the A/V mini-plug is firmly inserted into the back of the XaviXPORT.

\*XaviXPORT typically sold separately unless clearly indicated on the package that the PORT is included.

### 3 Insert System Cartridge.

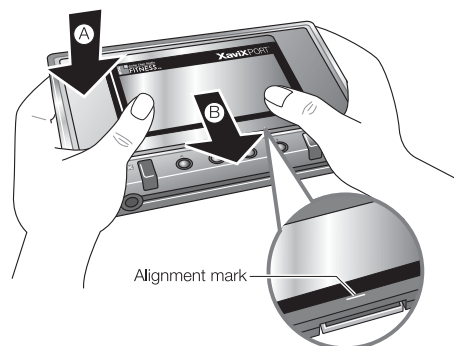

INSERT the cartridge into the PORT and slide the cartridge towards the front of the PORT. Press the PORT power switch and check to be sure the green power light is on.

## Quick Setup Guide

### 4 Install Batteries in the J-MAT.

①

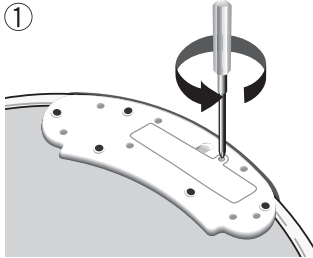

1. Fold or turn over the J-MAT so that its rear side is facing up. Unscrew the Battery Door using a small Phillips head screwdriver and remove.

②

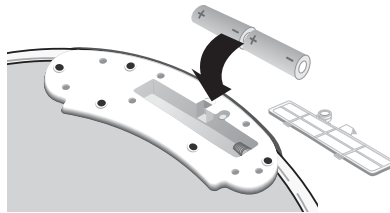

2. Insert the batteries making sure that the + and - ends are facing the correct direction.

③

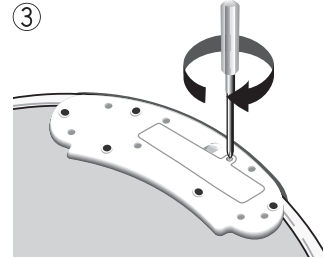

3. Attach the Battery Door and screw in the Battery Door.

## How to use

### 1 How to use the J-MAT.

#### Distance and Angle

##### Side view

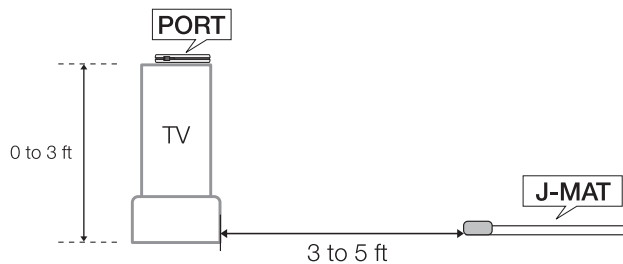

##### Top view

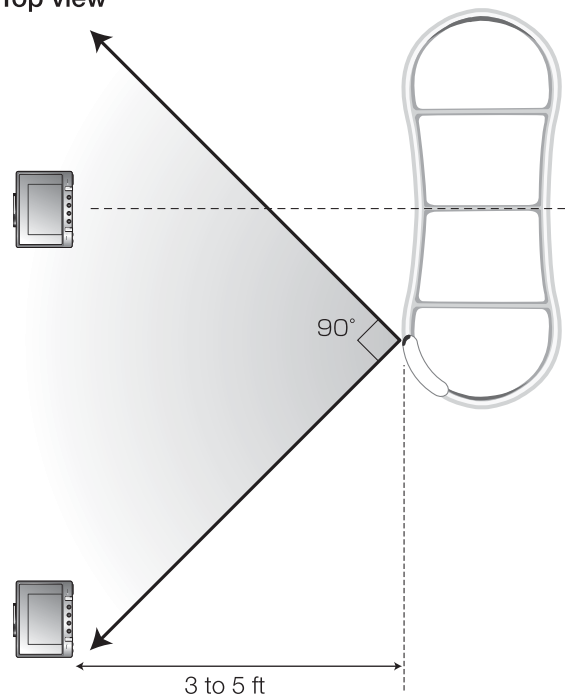

\* For further details, refer to the “XaviXPORT User’s Guide” “J-MAT User’s Guide”.